



TAV-506 v.2 (5.0 system)

TAV-506F v.2 (floorstanding speaker)

The second version of TAV-506 is not just the same model as before with only a few cosmetic changes, but a totally redesigned construction, which brings this speaker set a whole level up in terms of sound performance.

The main challenge for our designers and acoustic engineers was to combine high quality sound in stereo systems (for front floorstanding speakers) and astonishingly dynamic resolution in home theatre. It seems a very easy task to do, but only a few speaker companies can achieve it and TAGA is one of them.

It is not only about utilizing best components and design, the real art behind the construction is final adjustment of sound balance, which is where our acoustic engineers have shown their craftsmanship.

Final result is a smooth, detailed and balanced performance with huge dynamics and rich, high resolution sound throughout the whole frequency range.

Add to this an appealing, yet classic design – TAV-506 v.2 is a perfect choice both for stereo and home theatre.

There are 2 packages available: full 5.0 system TAV-506 v.2 (including floorstanding, center and surround speakers) and separately sold floorstanding speakers TAV-506F v.2

Available in 3 modern finishes: Black, Wenge and Walnut.

SPECIFICATIONS

Model:	TAV-506F v.2	TAV-506C v.2	TAV-506S v.2
Design:	3-way, floorstanding	2-way, center	2-way, surround
High-Frequency Driver:	25mm (1"), TWG faceplate, silk dome	25mm (1"), TWG faceplate, silk dome	25mm (1"), TWG faceplate, silk dome
Bass / Midrange Driver:	133mm (5.25"), glass fiber cone	2 x 102mm (4"), paper cone	102mm (4"), paper cone
Bass Driver:	2 x 133mm (5.25"), paper cone	-	-
Recommended Amplifier Power:	20-120W	20-100W	20-100W
Frequency Response (+/- 3dB):	42Hz-25KHz	55Hz-25KHz	55Hz-25KHz
Impedance:	6 ohm	6 ohm	6 ohm
Sensitivity:	89 dB	88 dB	86 dB
Dimensions (H x W x D):	90 x 17 x 23,5 cm (excl. spikes)	14 x 40 x 14.5 cm	24.5 x 14 x 14.5 cm
Weight (net):	20.4 kg pair	2.8 kg pcs.	3.5 kg pair

TECHNOLOGY

CABINETS

Cabinets are made of high-quality PVC coated MDF boards (9mm thick with 12mm front panel) with inside braces in floorstanding model to increase stiffness and limit any unwanted resonances.

The shapes are perfectly crafted not only to look slim and modern but mainly to lower any unwanted vibrations, diffractions or turbulences, which can affect the sound performance.

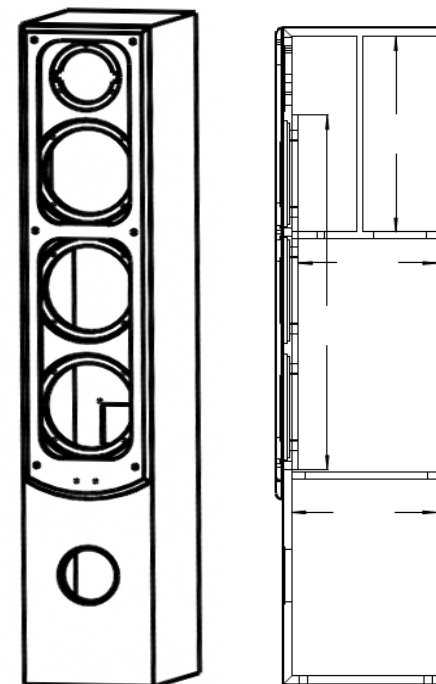

TWEETER

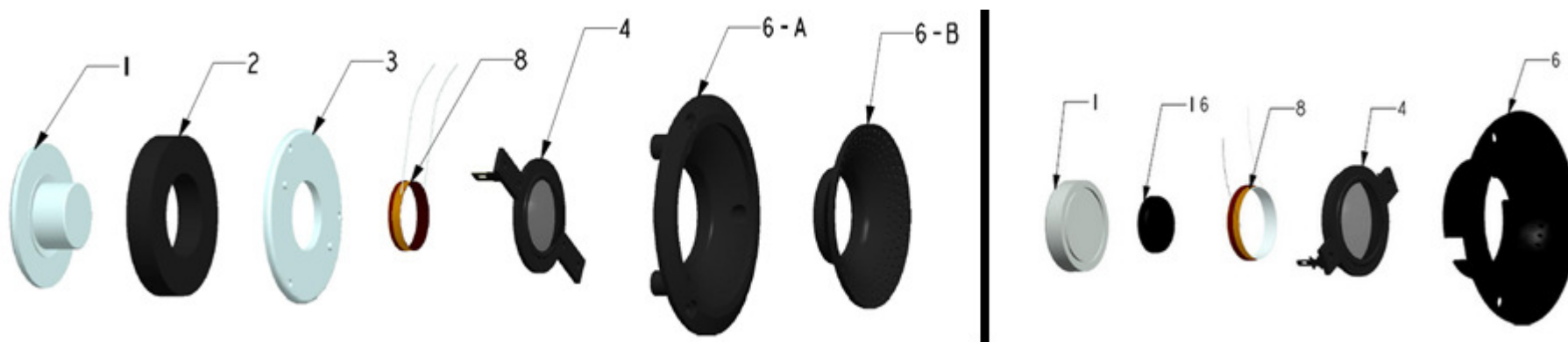

TAV-506F v.2

1. T-YOKE / Pole piece
2. Oversized ferrite magnet
3. Top plate
4. Black silk dome
- 6-A, 6-B. TWG Front faceplate
8. Flat wire aluminum voice coil
16. Black sponge

TAV-506C/S v.2

1" (25mm) silk dome tweeter with oversized magnet ($\Phi 70$ in F model), ferrofluid cooling and heavy duty flat wire aluminum voice coil can handle high power and its performance is very accurate, clear, smooth and detailed. Specialized horn-like, **TWG** TAGA Waveguide design of tweeter's faceplate utilizing concave diffusers supports equal and flat dispersion of sound in and off the axis of the driver.

MID-RANGE DRIVER (FRONT SPEAKER)



1. T-YOKE / Pole piece
2. Oversized ferrite magnet
3. Top plate
7. Ferrum injection-molded chassis with anti-oxidation surface process
8. Flat wire copper voice coil
9. Terminal
10. Spider
11. Yellow glass fiber cone and rubber surround
12. PP bullet shape dust cap

Rigid and ultra-light yellow glass fiber cone with the elastic rubber suspension can move very fast and frequently allowing mid-range frequencies to be very rich, spacious and sweet. Heavy duty voice coil and $\Phi 70$ magnet can stand high temperatures and power inputs. The dust cap in the form of bullet improves dispersion at higher range of mid frequencies.

WOOFER AND MID-RANGE/WOOFER



TAV-506F v.2

1. T-YOKE / Pole piece
2. Oversized ferrite magnet
3. Top plate
7. Ferrum injection-molded chassis with anti-oxidation surface process
8. Flat wire copper voice coil
9. Terminal
10. Spider
11. Paper cone and rubber surround
12. PP bullet shape dust cap

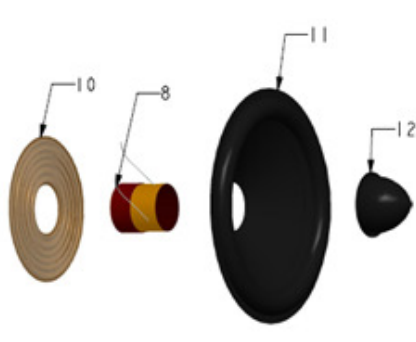

TAV-506C/S v.2

Woofers utilizing paper cone and heavy duty voice coil and coil former for increased power handling, can play deep, precise and detailed bass as well as clear, rich and spacious mid frequencies. The dust cap in the form of bullet improves dispersion at higher range of low and mid frequencies.

BASSREFLEX PORTS

Low-turbulence and high-velocity ports utilizing concave diffusers for increased dispersion of low frequencies.

CROSSOVERS

High quality, close-tolerance and precisely selected crossovers' components and internal wires for absolute sound neutrality, high long-term power and reliability.

INTERNAL WIRING

TAGA Harmony utilizes high quality internal wiring connecting crossovers with drivers assuring that incoming audio signals from receiver or amplifier will not lose any important details on the paths to drivers.

SPEAKER'S BINDING POSTS

All speakers (including center and surround speakers) use high quality, gold-plated banana binding posts accepting raw speaker cables up to 10AWG and most popular types of connectors.