



Available Finishes*:



WALNUT BLACK WENGE HIGH GLOSS WHITE HIGH GLOSS BLACK

*) Actual colors of finishes may vary from above images.
More colors of finishes available upon request.

PLATINUM SLIM Series

Honey, I shrunk the Platinum!

You love the excellent sound of our award-winning and highly acclaimed Platinum series but your spouse would be furious seeing big boxes in your living room. Here comes the solution! The solution means no any substitutions or compromises were used but just like in an old good movie: the Platinum series has just been shrunk to more compact, appealing SLIM version.

Surely we had to tune crossovers as well as add a passive radiator to the floorstanding model to ensure the same tonal character which the Platinum series is famous of.

The same, high-end technology used in Platinum has been implemented in the Platinum SLIM series: The TPTTD Pure Titanium Dome tweeter reaching remarkable 40KHz top frequency with TWG TAGA Waveguide design allowing to farther widen the dispersion of highs around the room. The TTP Top Plate with highly placed tweeter reduces standing waves effect and creates three-dimensional performance. The TPACD Pure Aluminum Cone midrange and bass drivers with tuned performance to meet requirements of new cabinets.

To emphasize the slim appearance of the F-90 SLIM floorstanding model we have designed a new compact yet elegant plinth which helps isolating a speaker from a floor.

From the very first audition you can hear and feel the WOW factor!

Whether you enjoy your favorite music or movie Platinum SLIM series always delivers the high-end sound with striking clarity and spaciousness as well as dynamic low bass at any volume.

SPECIFICATIONS

MODEL:	PLATINUM F-90 SL	PLATINUM C-90 SL	PLATINUM S-90 SL
Design:	Floorstanding 3-way, 5 drivers, Bi-wiring, 15mm MDF TLIE enclosure Crossover points 700Hz, 3.7kHz	Center 2-way, 3 drivers, Wall mounts 12mm MDF TLIE enclosure Crossover points 3.5kHz	Surround 2-way, 2 drivers, Wall mounts 12mm MDF TLIE enclosure Crossover points 4.3kHz
High-Frequency Driver:	25mm (1") TPTTD, TWG, TTP	25mm (1") TPTTD, TWG, TTP	25mm (1") TPTTD, TWG, TTP
Bass / Midrange Driver:	133mm (5.25") TPACD	2 x 133mm (5.25") TPACD	133mm (5.25") TPACD
Bass Driver:	2 x 133mm (5.25") TPACD	-	-
Passive Radiator:	133mm (5.25") TPADR	-	-
Recommended Amplifier Power:	20-240W	20-120W	20-120W
Frequency Response (+/- 3dB):	31Hz - 40kHz	42Hz-40kHz	44Hz-40kHz
Impedance:	4-8 ohm	4-8 ohm	4-8 ohm
Sensitivity:	91dB	88dB	87dB
Dimensions (H x W x D):	103.5 x 17 x 24.5 cm	15 x 52 x 18 cm	26 x 17 x 15 cm
Weight (net):	32.6 kg pair 35.5 kg pair (High Gloss)	5.9 kg pcs. 7.1 kg pcs. (High Gloss)	6.6 kg pair 7.9 kg pair (High Gloss)

Floorstanding models: the height excluding spikes and including a base. The weight including a base.

TECHNOLOGY

CABINETS

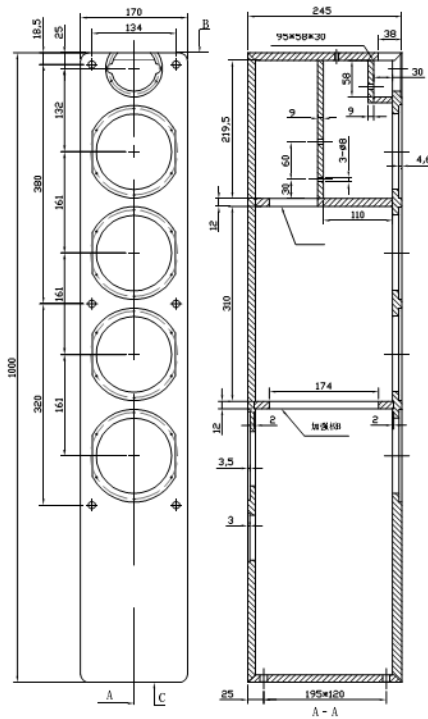

TLIE – Taga Low Interference Enclosures are made of high-quality 15mm thick MDF boards (12mm for Center and Surround speaker) with inside braces (floorstanding models) to increase stiffness and limit any unwanted resonances.

The slim shapes of cabinets are perfectly crafted not only to look wonderful and modern but mainly to lower any unwanted vibrations, diffractions or turbulences, which can affect the sound performance.

Acoustical damping material used inside cabinets eliminates problem of internal standing waves and bass-reflex ports are uniquely designed to reduce distortions to minimum.



Floorstanding models sit on massive bases with spikes that provide stability and good isolation of speakers from the floor.

HIGH CLASS HIGH GLOSS PAINTING (selected models)

Minimum 5 layers of paint plus 1 layer of the base coat.

Left figures show F-90 SL cabinet structure.

BASSREFLEX PORTS

BOM Bassreflex Omnidirectional Module - low-turbulence and high-velocity ports utilizing concave diffusers for increased dispersion of low frequencies.



CROSSOVERS

High quality, close-tolerance and precisely selected crossovers' components and internal wires for absolute sound neutrality, high long-term power and reliability. TAGA Harmony utilizes high quality of internal wiring connecting crossovers with drivers assuring that incoming audio signals from receiver or amplifier will not lose any important details on the paths to drivers.

SPEAKER'S BINDING POSTS

All speakers (including center and surround speakers) use high quality, gold-plated banana binding posts accepting raw speaker cables up to 10AWG and most popular types of connectors. The front speakers use upgraded, high-end banana binding posts allowing bi-wiring for wider dispersions and spaciousness, higher sonic accuracy and more precise location.

TWEETER

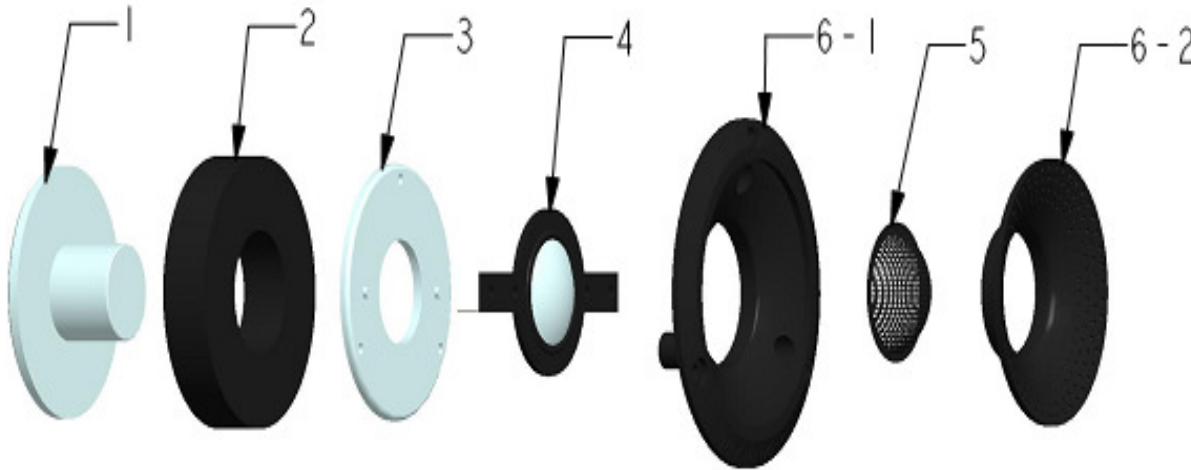

1. T-YOKE / Pole piece
2. Oversized ferrite magnet
3. Top plate
4. TPTTD Pure-titanium dome and Copper-Clad Aluminum Wire (CCA) voice coil with silver wiring
5. Metal grill
6. TWG Front faceplate

1" (25mm) **TPTTD** Taga Pure Titanium Tweeter Dome with oversized $\Phi 70$ magnet, ferrofluid cooling and heavy duty CCAW and silver wiring voice coil, the tweeter can bear high power and its performance is very accurate, clear, smooth and detailed.



Specialized horn-like, **TWG** TAGA Waveguide design of tweeter's faceplate utilizing concave diffusers as well as dome metal grill assists with equal and flat dispersion of sound in and off the axis of the driver. CCAW voice coil ensures crisp, clean and distortion free communication and high power sound. Platinum tweeter can perform up to 40KHz!

TTP Taga Top Plate reduces standing waves effect and creates three-dimensional performance.

MIDRANGE

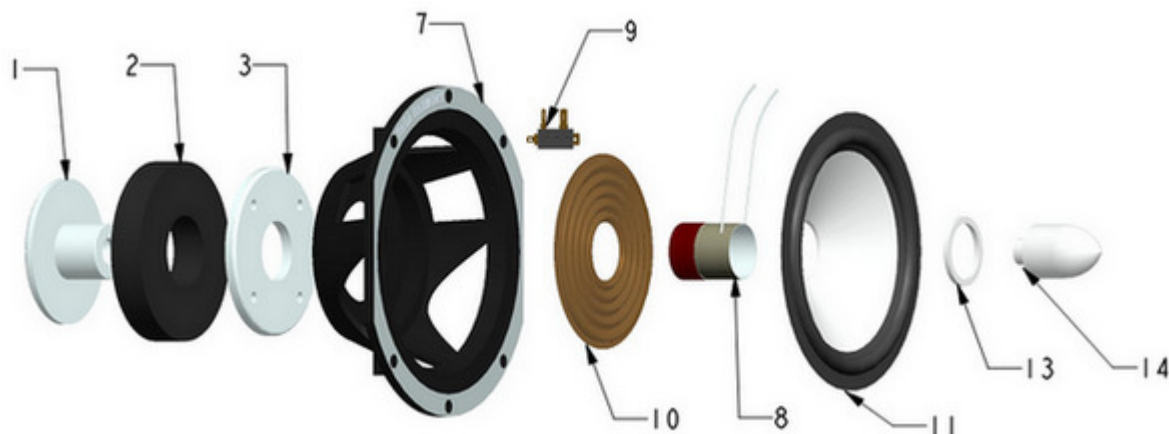

1. T-YOKE / Pole piece
2. Oversized ferrite magnet
3. Top plate
7. Aluminum injection-molded chassis with anti-oxidation surface process
8. Flat wire copper voice coil
9. Terminal
10. Spider
11. TPACD Pure aluminum cone and rubber surround
13. Silver plastic ring
14. Pure aluminum bullet shaped phase plug

Rigid and ultra-light **TPACD** Taga Pure Aluminum cone Driver (with aluminum bullet shaped phase plug and chassis, oversized $\Phi 90$ magnet) with the butyl suspension can move very fast and frequently allowing mid-range frequencies to be very rich, spacious and sweet. Heavy duty combo T-yoke, pure copper voice coil can stand high temperatures and power inputs. The still, bullet shaped phase plug is to align the phase of the audio signal and to smooth the midrange frequency response.

WOOFER / MID-WOOFER

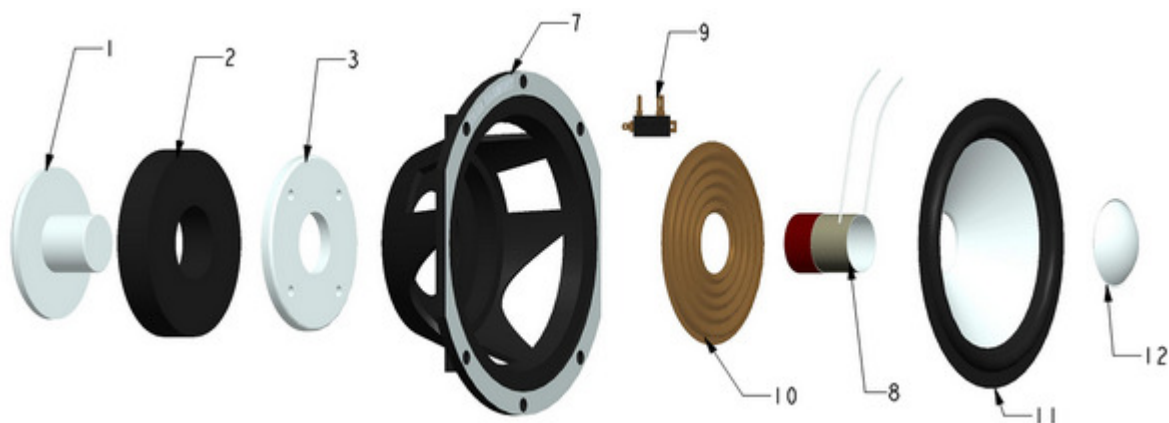

1. T-YOKE / Pole piece
2. Oversized ferrite magnet
3. Top plate
7. Aluminum injection-molded chassis with anti-oxidation surface process
8. Flat wire copper voice coil
9. Terminal
10. Spider
11. TPACD Pure aluminum cone and rubber surround
12. Pure aluminum dust cap

TPACD Taga Pure Aluminum cone Driver (with aluminum dust caps and chassis, oversized $\Phi 100$ magnet) and heavy duty combo T-yoke, pure copper voice coil, all of which allow for a high power handling as well as deep, precise and detailed bass performance (and detailed, rich and spacious midrange frequencies in mid-woofers models).

5.25" PASSIVE RADIATOR (PLATINUM F-90 SL)



TPAPR Taga Pure Aluminum Passive Radiator (pure aluminum cone, dust cap and chassis). Very light cone and elastic rubber suspension allow fast and accurate movement of the cone by an internal air pressure produced by bass active drivers. Extra 85g steel load to increase a damping factor.

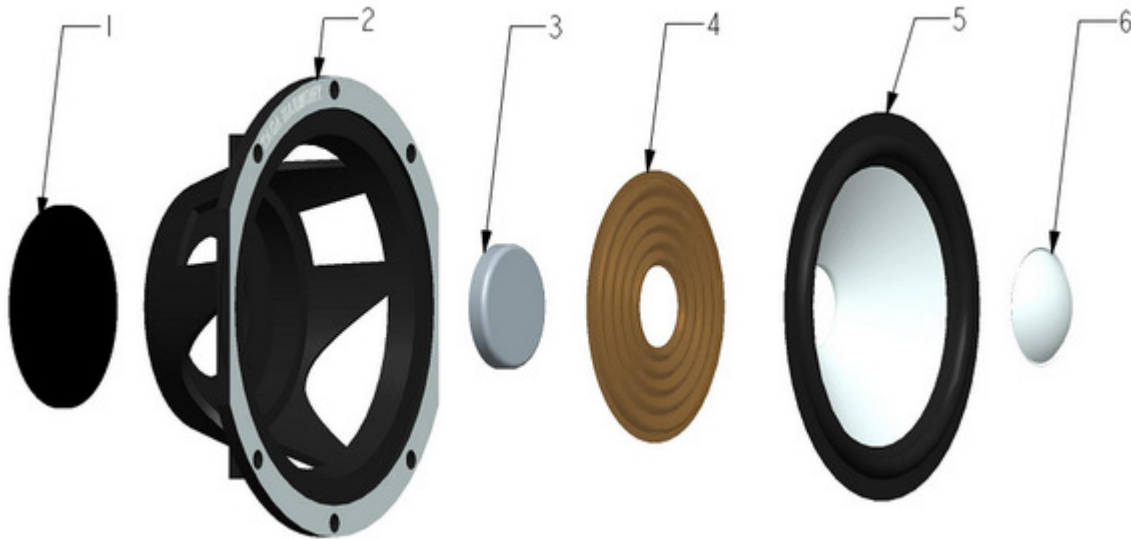

1. Rear cover
2. Aluminum injection-molded chassis with anti-oxidation surface process
3. 85g steel piece
4. Spider
5. Pure aluminum cone and rubber surround
6. Pure aluminum dust cap