



AZURE Series - The taste of Côte d'Azur!

You are of course familiar with the French Riviera, which stretches over a hundred kilometers of coastline where the beautiful colored Mediterranean Sea closes in around amazing cliffs, sandy beaches and exquisite resorts.

We named our speakers series "AZURE" to emphasize their sound character, which is like sea's breeze powerful and gentle at the same time, and gives the joy of listening like watching azure color of the Mediterranean Sea. And the design of AZURE series is elegant, awesome and stylish, so there is no doubt that our speakers can shine like stars in the backdrop of famous and luxurious resorts of the French Riviera.

Floorstanding models sit on solid base with spikes that provides stability and good isolation of speakers from the floor. All models utilize special construction of sleek front panel called TCDP (Taga Clear Design Panel) for better dispersion of frequencies from individual drivers.

AZURE series is dedicated for demanding hi-fi and home-theatre sound enthusiasts, who look for best sound performance as well as love to enjoy sound without missing any single tune of melody!

Available in 3 modern finishes: Black, Wenge and Walnut, with front panel in high gloss black.

Picture shows (from the left): AZURE F-80, AZURE F-60, AZURE C-40, AZURE S-40

SPECIFICATIONS

MODEL:	AZURE F-80	AZURE F-60	AZURE B-40
Design:	3-way, 4 drivers, floorstanding, Bi-wiring, double bassreflex port, crossover points 600Hz 3kHz TLIE Enclosure, TCDP front panel	2-way, 3 drivers, floorstanding, Bi-wiring, rear bassreflex port, crossover point 3kHz, TLIE Enclosure, TCDP front panel	2-way, 2 drivers, Bookshelf speakers, rear bassreflex port, crossover point 2.5kHz, TLIE Enclosure, TCDP front panel
High-Frequency Driver:	25mm (1") TPTTD	25mm (1") TPTTD	25mm (1") TPTTD
Midrange Driver:	133mm (5.25") TCFCFCD	-	165mm (6.5") TCFCFCD
Bass Driver:	2 x 165mm (6.5") TCFCFCD	2 x 165mm (6.5") TCFCFCD	20-110W
Recommended Amplifier Power:	20-180W	20-150W	48Hz-40kHz
Frequency Response (+/- 3dB):	40Hz - 40kHz	42Hz-40kHz	6 ohm
Impedance:	6 ohm	6 ohm	88dB
Sensitivity:	89dB	88dB	35 x 21 x 31.8 cm
Dimensions (H x W x D):	100,5 x 21 x 27 cm (incl. base, excl. metal feet/spikes)	92.5 x 21 x 27 cm (incl. base, excl. metal feet/spikes)	13.6 kg pair
Weight (net):	36 kg pair (excl. base)	30.6 kg pair (excl. base)	

MODEL:	AZURE C-40	AZURE S-40
Design:	2-way, 3 drivers, Center speaker, double rear bassreflex port, wall mounts, crossover point 4.5kHz, TLIE Enclosure, TCDP front panel	2-way, 2 drivers, Surround speakers, rear bassreflex port, wall mounts, crossover point 4.5kHz, TLIE Enclosure, TCDP front panel
High-Frequency Driver:	25mm (1") TPTTD	25mm (1") TPTTD
Bass / Midrange Driver:	2 x 101mm (4") TCFCFCD	101mm (4") TCFCFCD
Recommended Amplifier Power:	20-100W	20-100W
Frequency Response (+/- 3dB):	50Hz-40kHz	50Hz-40kHz
Impedance:	6 ohm	6 ohm
Sensitivity:	88dB	87dB
Dimensions (H x W x D):	16.5 x 45 x 20 cm	28 x 16.5 x 20 cm
Weight (net):	5.1 kg pcs.	6.2 kg pair

- **Note:** AZURE series speakers are not equipped with grills.

TECHNOLOGY

CABINETS

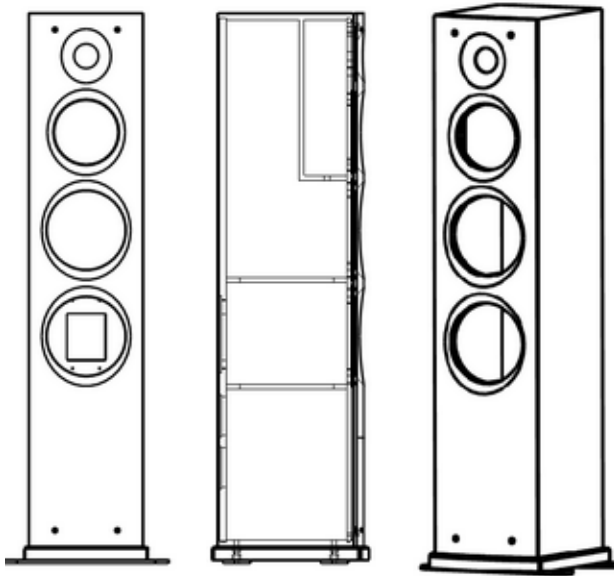

TLIE – Taga Low Interference Enclosures are made of high-quality thick PVC coated MDF boards (Front and Bookshelf speakers: 12mm full cabinet with an extra 18mm thick TCDP front panel. Center and Surrounds speakers: 9mm full cabinet with an extra 12mm thick TCDP front panel) to increase stiffness and limit any unwanted resonances. Front speakers have additional inside braces made of 9mm MDF boards.

The shapes are perfectly crafted not only to look wonderful and modern but mainly to lower any unwanted vibrations, diffractions or turbulences, which can affect the sound performance. Acoustical damping material used inside cabinets eliminates problem of internal standing waves and bass-reflex ports are uniquely designed to reduce distortions to minimum.

Floorstanding models sit on solid MDF base with metal feet and spikes that provides stability and good isolation of speakers from the floor.

All models utilize special construction of sleek front panel called **TCDP** Taga Clear Design Panel with horn-like shaped holes for drivers for better dispersion of frequencies from individual drivers.

Left figure shows Azure F-80 cabinet; right – TCDP panel.

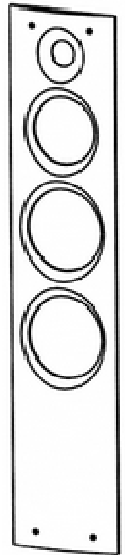

BASSREFLEX PORTS

Low-turbulence and high-velocity port utilizing concave diffusers for increased dispersion of low frequencies.

CROSSOVERS

High quality, close-tolerance and precisely selected crossovers' components and internal wires for absolute sound neutrality, high long-term power and reliability.

INTERNAL WIRING

TAGA Harmony utilizes high purity oxygen free copper OFC for internal wiring connecting crossovers with drivers assuring that incoming audio signals from receiver or amplifier will not lose any important details on the paths to drivers.

SPEAKER'S BINDING POSTS

All speakers (including center and surround speakers) use high quality, gold-plated banana binding posts accepting raw speaker cables up to 10AWG and most popular types of connectors. Front speakers use upgraded, high-end banana binding posts allowing bi-wiring for wider dispersions and spaciousness, higher sonic accuracy and more precise location.

TWEETER



1. T-YOKE / Pole piece
2. Oversized ferrite magnet
3. Top plate
4. TPTTD Pure-titanium dome and Copper-Clad Aluminum Wire voice coil with silver wiring
5. Metal grill
6. Front faceplate
8. Flat wire copper voice coil
16. Black sponge

1" (25mm) **TPTTD** Taga Pure Titanium Tweeter Dome and Copper-Clad Aluminum Wire voice coil with silver wiring, oversized $\Phi 70$ magnet, ferrofluid cooling and heavy duty voice coil can bear high power and its performance is very accurate, clear, smooth and detailed. Dome metal grill assists with equal and flat dispersion of sound in and off the axis of the driver. High quality voice coil ensures crisp, clean and distortion free communication and high power sound.

Our tweeter can perform up to 40KHz!

MID-RANGE DRIVER (AZURE F-80)

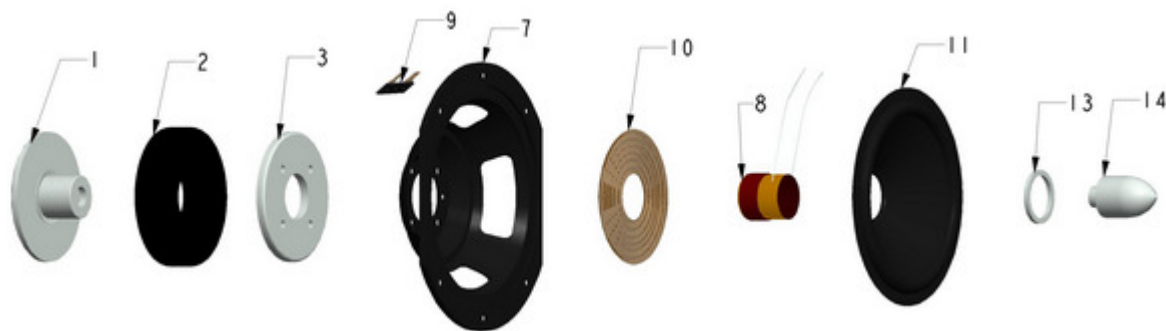

1. T-YOKE / Pole piece
2. Oversized ferrite magnet
3. Top plate
7. Ferrum injection-molded chassis with anti-oxidation surface process
8. Flat wire copper voice coil
9. Terminal
10. Spider
11. TCFCD Taga Carbon Fiber Cone Driver and rubber surround
13. Silver plastic ring
14. Pure aluminum bullet shape dust cap

Rigid and ultra-light **TCFCD** Taga Carbon Fiber Cone Driver with oversized $\Phi 80$ magnet and the butyl suspension can move very fast and frequently allowing mid-range frequencies to be very rich, spacious and sweet. Heavy duty combo T-yoke and voice coil with copper wiring can stand high temperatures and power inputs. The still, bullet shaped dust cap improves dispersion at higher range of mid frequencies.

WOOFER / MID-WOOFER



AZURE F-80/B-40

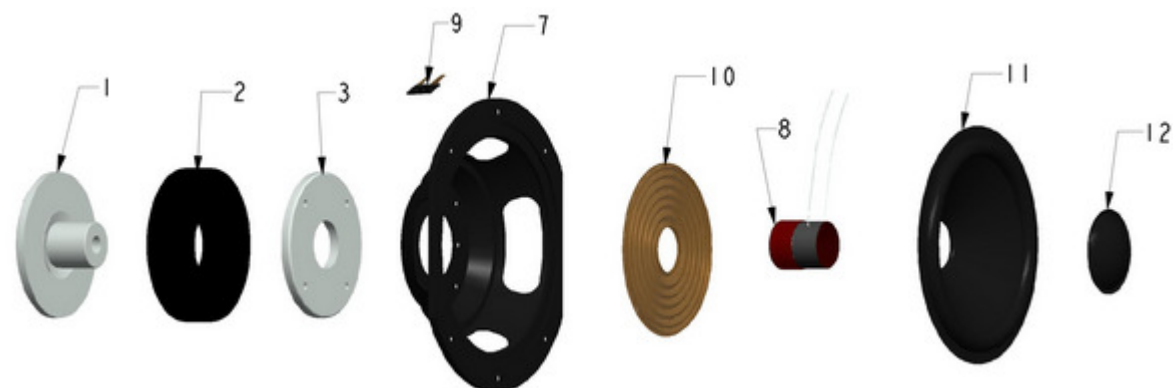

AZURE F-60



AZURE C and S

1. T-YOKE / Pole piece
2. Oversized ferrite magnet
3. Top plate
7. Ferrum injection-molded chassis with anti-oxidation surface process
8. Flat wire copper voice coil
9. Terminal
10. Spider
11. TCFCD Taga Carbon Fiber Cone Driver and rubber surround
12. Carbon fiber dust cap
15. Vice oversized ferrite magnet

TCFCD Taga Carbon Fiber Cone Driver with oversized $\Phi 100$ magnet ($\Phi 70$ in C/S models, extra vise magnet in F-80/B-40), carbon fiber dust cap and heavy duty combo T-yoke, voice coil and coil former with pure copper wiring is responsible for high power handling as well as deep, precise and detailed bass (and detailed, rich and spacious midrange frequencies in mid-woofers models).